

SEE DRAWING 1 FOR SITE LOCATION DETAILS

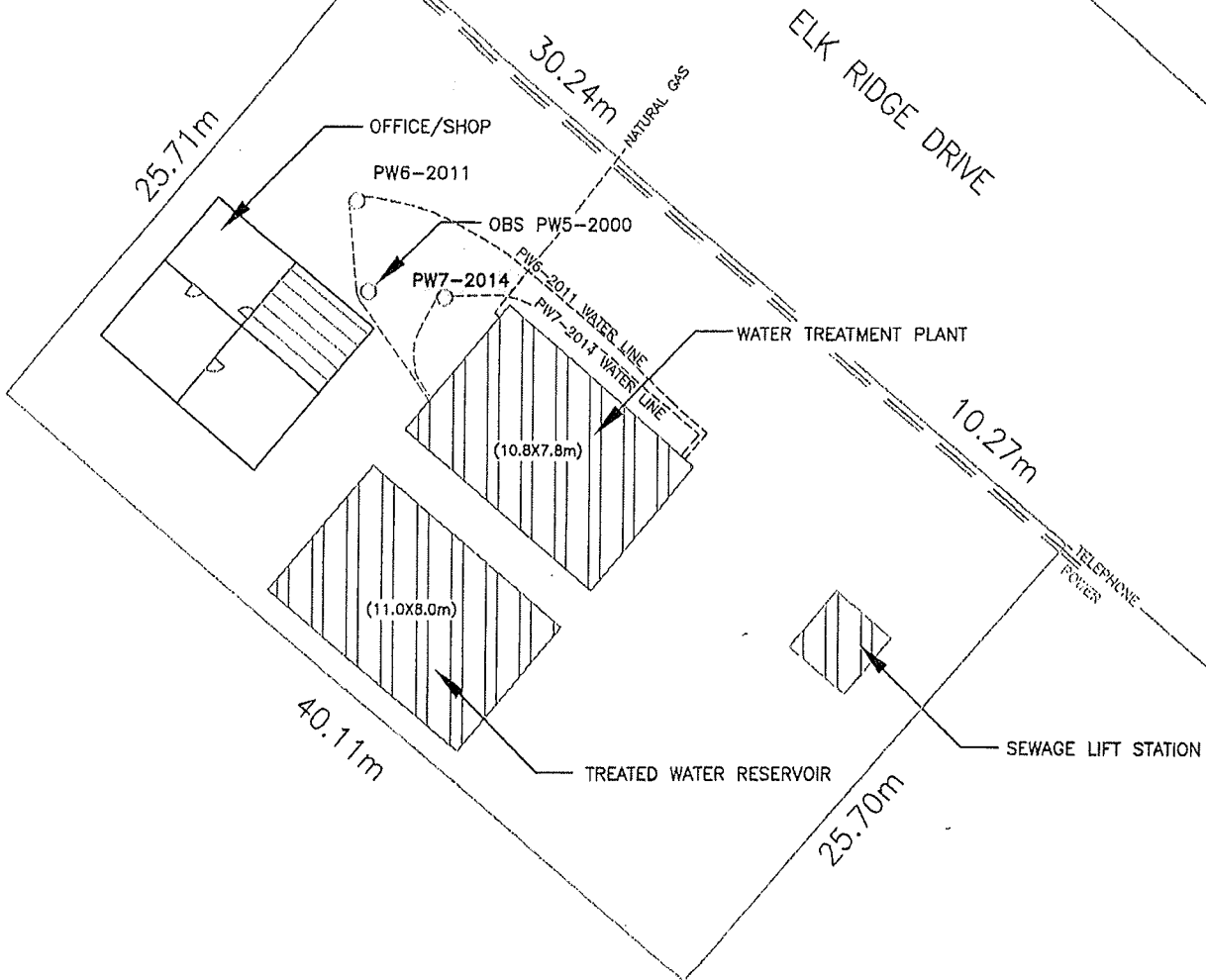

- NOTES : PW7-2014 WATER LINE - 1.83 METRES OF 51mm HDPE PIPE CONNECTING PITLESS ADAPTER TO THE 38.1mm HDPE PIPE REUSED FROM PW5-2000.
- : PW6-2011 WATER LINE IS ALSO 51mm HDPE PIPE.
- : WATER LINES ARE 3.35 METRES DEEP AND RUN PARALLEL TO THE WATER TREATMENT BUILDING 1.22 METRES TO THE NW.
- : BOTH WATER LINES ARE LOCATED IN THE SAME TRENCH.
- : POWER LINE FROM PW5-2000 WAS REUSED FOR PW7-2014.

UNDERGROUND UTILITIES AND BUILDING LOCATIONS ARE APPROXIMATED.

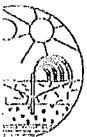

BECKIE HYDROGEOLOGISTS (1990) LTD.
CONSULTING ENGINEERS AND GEOSCIENTISTS
APEGS CERTIFICATE OF AUTHORIZATION No. 664

IN BY S.M.FAMULAK
ROVED BY M.FAMULAK
: OCTOBER 2, 2014

DESCRIPTION:
RECORD DRAWING

ELK RIDGE UTILITY LTD.

SCHEMATIC LOCATION DRAWING
ELK RIDGE UTILITY WELL SITE
SURFACE PARCEL # 135813506

ACAD FILE:
ELKRIDGE_SCHEMATIC.DWG
SCALE:
1cm = 3.00m
DRAWING NO.
2
PLOT DATE:
OCT. 30, 2014

3
E
14