

RESORT VILLAGE OF ELK RIDGE

BYLAW 17-2022

A BYLAW TO PROVIDE FOR THE NUMBERING OF HOUSES AND OTHER BUILDINGS

The Council of the Resort Village of Elk Ridge in the Province of Saskatchewan enacts as follows:

1. This bylaw shall be referred to as the Civic Addressing Bylaw.
2. A uniform system of numbering houses and other buildings is hereby established and is shown on the attached map identified as Schedule "A", appended hereto and forming a part of this bylaw.
3. A separate number shall be assigned for each titled property. In the Condominiums, each titled property will use the number of their lot as in the Condominium Subdivision Plan. In the case of amalgamated lots in the Estates, the even lot number is assigned to the double lot.
4. Each house or building shall bear the assigned number to the frontage on which the front entrance is situated.
5. In case a house or building is occupied by more than one family dwelling unit or business, each separate front entrance of said house or building shall bear:
 - a) the same number extended with a letter of the alphabet beginning with the letter "A" and proceeding with as many as are required.
 - b) individual numbers have been assigned and displayed for the 10 cabins, 8 duplexes, the 48 modular units and the 16 dormitory units. These numbers will be retained for their addresses within the numbered buildings.
6. Numerals indicating the official number of each house or building or each front entrance shall be posted in a manner as to be visible from the street on which the property is located.

7. The Administrator shall be responsible for maintaining the numbering system and shall keep a record of all numbers assigned under this bylaw.

8. Any person/corporation who contravenes the provisions of this bylaw is guilty of an offence and upon conviction shall be liable
 - a. In the case of an individual or corporation:
 - i. for a first offence
 1. to a fine of not more than \$100.00; and
 - ii. for a second subsequent offence
 1. to a fine of not more than \$500.00.

9. All existing numbers of houses and other buildings not now conforming to the provisions of this bylaw shall be changed to conform to the system herein adopted.

Furthermore, this bylaw provides for the Civic Addresses of Houses and other Buildings within the Resort Village of Elk Ridge according to the attached map as "Schedule A".

The Council of the Resort Village of Elk Ridge, in the Province of Saskatchewan, enacts the civic addresses for Elk Ridge houses and building as follows:

Arne Petersen Way:	The Wyld Restaurant	211A Arne Petersen Way
	Elk Ridge Golf Pro Shop	211B Arne Petersen Way
	Elk Ridge Lodge	221 Arne Petersen Way
	Utility Building	232 Arne Petersen Way
	Elk Ridge Rental Cabins	231 Arne Petersen Way
Elk Ridge View:	Maintenance Compound	290 Elk Ridge View
	Sasktel Tower	290 Elk Ridge View

Elk Ridge Place:	Elk Ridge Church	181 Elk Ridge Place
	Elk Ridge RV Park	183 and 184 Elk Ridge Place
	Fire Hall	200 Elk Ridge Place
	TreeOSix	190 Elk Ridge Place
	Staff Duplexes	192 and 194 Elk Ridge Place
	Staff Modular	196 Elk Ridge Place
	Staff Dormitory	198 Elk Ridge Place

FAIRWAY DRIVE: Formerly 310 Elk Ridge View, Condominium Plan 01PA09047:

Numbers for Units 1 through 28 on Condo Plan 01PA09047 are retained as respective Unit Numbers. Original numbering of Units 1 through 28 are now the addresses 1 through 28 on the street named Fairway Drive.

EAGLE VIEW WAY: Formerly 251 Elk Ridge Drive on Condominium Plan 00PA03157:

Numbers for Units 1 through 67 on Condo Plan 00PA03157 are retained as respective Unit numbers. Units 1,2 and 3 are undeveloped. Original numbering of Units 4 through 67 are now the addresses 4 through 67 on the street named Eagle View Way.

ESTATES DRIVE: Formerly 110 Elk Ridge Drive on Condo Plan 99PA21324:

Numbers for Units 1 through 111 on Condo Plan 99PA21324 are retained as respective Unit numbers. Original numbering of Units 1 through 111 are now the addresses 1 through 111 on the street named Estates Drive. In the case of amalgamated lots, the even number shall be used to designate the double property:

1. amalgamated Units 51 and 52, that are now identified as Unit 113, are changed to the address number 52; and
2. amalgamated Units 79 and 80, that are now identified as Unit 112, are changed to the address number 80.

COTTAGE CRESCENT: Formerly 191 Elk Ridge Drive on Condo Plan 102093241:

Numbers for Units 1 through 39 on Condo Plan 102093241 are retained as respective Unit numbers. Original numbering of units 1 through 39 are now the addresses 1 through 39 on the street named Cottage Crescent.

This bylaw shall come into effect on the day of its final passing.



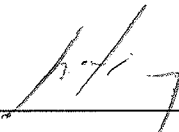

Mayor



Administrator

Read a third time and adopted
this 12th day of July, 2022.

Schedule "A" Elk Ridge Civic Addressing

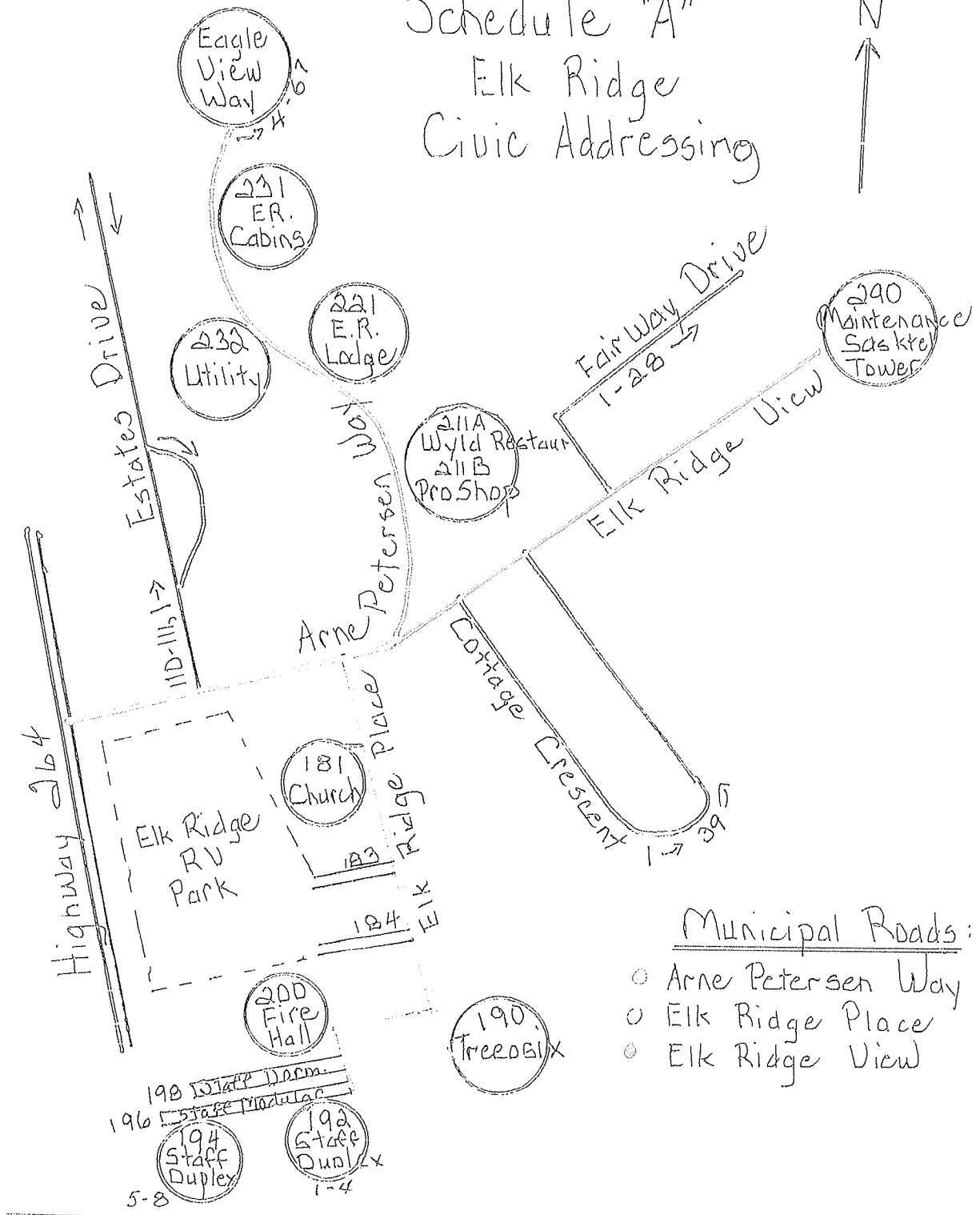

Municipal Roads:

- Arne Petersen Way
- Elk Ridge Place
- Elk Ridge View